

Getting Started...

Finding Data Profiles from the American Community Survey using the American FactFinder Website

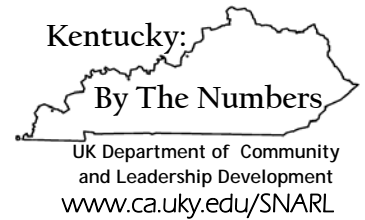

Julie N. Zimmerman, Rural Sociology. February 2012

Data Profile tables are one place where commonly used estimates from the American Community Survey can be located. The Data Profile tables are also useful in that they provide both estimates and well as pre-calculated percents.

This publication provides graphical instructions to help you find Data Profile tables from the American Community Survey using the American FactFinder website.

"Getting Started..." is a series of graphical website instructions designed to help in finding and using data from the internet.

Copies of this publication and others are available online at: <http://www.ca.uky.edu/snarl>. Just click on "Kentucky: By the Numbers."

American FactFinder

<http://factfinder2.census.gov>

The American FactFinder website from the U.S. Census Bureau provides online access to several data sources including the 2010 Census and the American Community Survey.

To help in locating data, the website uses provides filters to help narrow your search. These filters can be used in any order and in any combination.

This publication illustrates one way to find county-level Data Profiles from the American Community Survey.

The screenshot shows the American FactFinder website. At the top, it says "U.S. Census Bureau" and "AMERICAN FactFinder". There is a navigation bar with "MAIN", "SEARCH", "WHAT WE PROVIDE", and "USING FACTFINDER". Below this, there are several sections: "Your Selections" (empty), "Search using the options below:" with filters for Topics, Geographies, Race and Ethnic Groups, and Industry Codes; "Quick Start" with a search box and "GO" button; "U.S. Population Clock" showing "312,935,410"; and "Reference Maps" with a dropdown menu set to "United States".

COOPERATIVE
EXTENSION
SERVICE

UK

UNIVERSITY OF KENTUCKY
College of Agriculture

1. The most direct way to locate data for your county is to begin with the **"QUICK START"** box.

2. Type your county name. I'll use Mercer County.

As you type, a list will appear with all of the geographies possible that contain your county's name

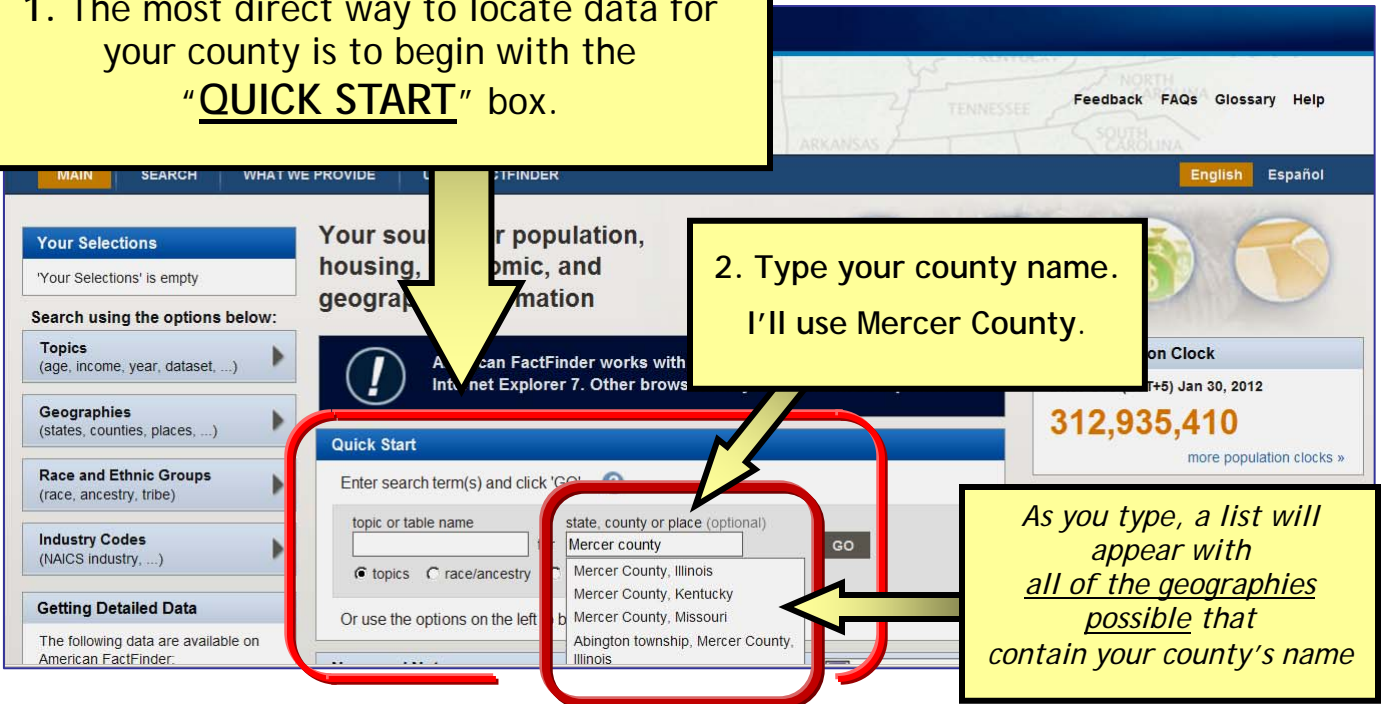

1. Since I want the Mercer County that is in Kentucky, that's what I picked.

2. Click "GO"

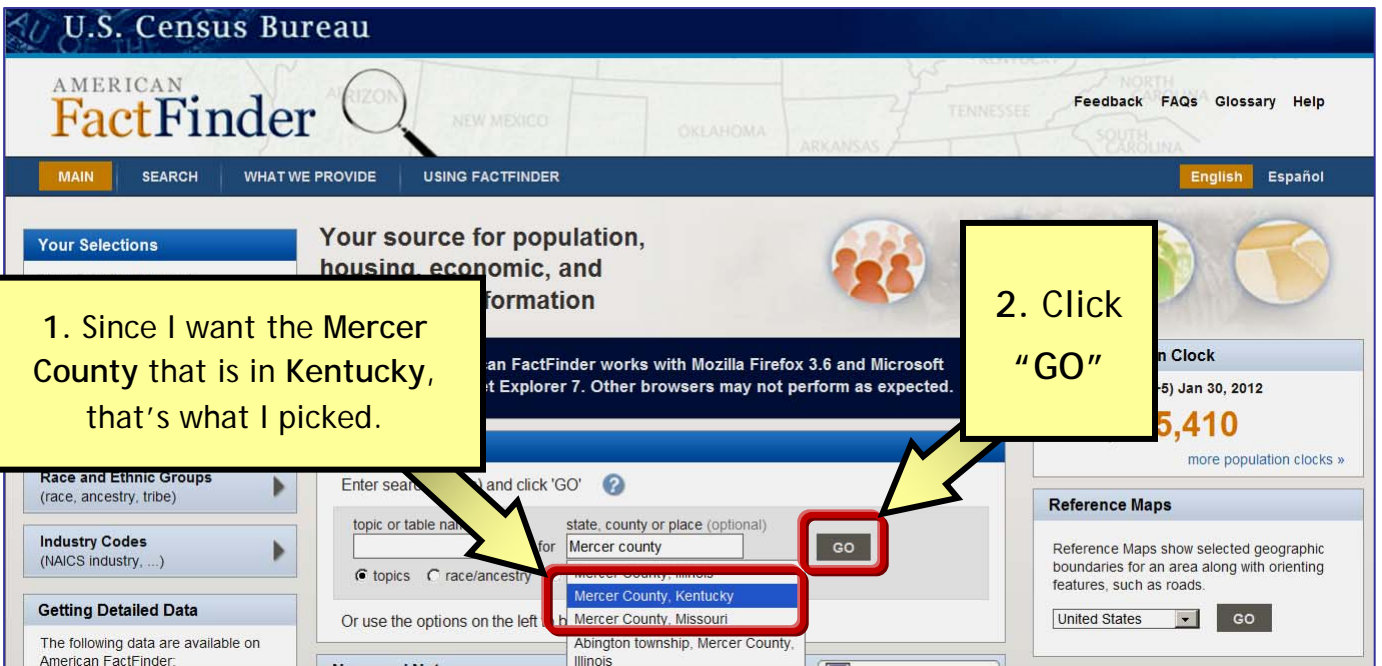

The results are always organized to show you:
 the Table ID, the Table Title,
 and the Dataset the table came from.

Your Selections
 Search using...
 County
 Mercer County, Kentucky

Search Results: 1-25 of 9,060 tables and other products match 'Your Selections' per page: 25

ID	Table, File or Document Title	Dataset	About
DP-1	Profile of General Population and Housing Characteristics: 2010	2010 Demographic Profile SF	
DP-1	Profile of General Population and Housing Characteristics: 2010	2010 SF2 100% Data	
DP02	SELECTED SOCIAL CHARACTERISTICS IN THE UNITED STATES	2010 ACS 3-year estimates	
DP02	SELECTED SOCIAL CHARACTERISTICS IN THE UNITED STATES	2010 ACS 5-year estimates	
DP03	SELECTED ECONOMIC CHARACTERISTICS	2010 ACS 3-year estimates	
DP03	SELECTED ECONOMIC CHARACTERISTICS	2010 ACS 5-year estimates	
DP04	SELECTED HOUSING CHARACTERISTICS	2010 ACS 3-year estimates	
DP04	SELECTED HOUSING CHARACTERISTICS	2010 ACS 5-year estimates	
DP05	ACS DEMOGRAPHIC AND HOUSING ESTIMATES	2010 ACS 3-year estimates	
DP05	ACS DEMOGRAPHIC AND HOUSING ESTIMATES	2010 ACS 5-year estimates	

This box always shows you which filters you picked. So far, we have only picked Mercer County, Kentucky.

Don't forget to scroll down for more tables.

So far, the results list includes EVERY table, for EVERY year, from EVERY dataset that contains "Mercer County, Kentucky." You can pick from this list OR you can narrow the list by using filters

(topics, geographies, ...) to narrow your search results

Search Results: 1-25 of 9,060 tables and other products match 'Your Selections' per page: 25

ID	Table, File or Document Title	Dataset	About
DP-1	Profile of General Population and Housing Characteristics: 2010	2010 Demographic Profile SF	
DP-1	Profile of General Population and Housing Characteristics: 2010	2010 SF2 100% Data	
DP02	SELECTED SOCIAL CHARACTERISTICS IN THE UNITED STATES	2010 ACS 3-year estimates	
DP02	SELECTED SOCIAL CHARACTERISTICS IN THE UNITED STATES	2010 ACS 5-year estimates	
DP03	SELECTED ECONOMIC CHARACTERISTICS	2010 ACS 3-year estimates	
DP03	SELECTED ECONOMIC CHARACTERISTICS	2010 ACS 5-year estimates	
DP04	SELECTED HOUSING CHARACTERISTICS	2010 ACS 3-year estimates	
DP04	SELECTED HOUSING CHARACTERISTICS	2010 ACS 5-year estimates	
DP05	ACS DEMOGRAPHIC AND HOUSING ESTIMATES	2010 ACS 3-year estimates	
DP05	ACS DEMOGRAPHIC AND HOUSING ESTIMATES	2010 ACS 5-year estimates	

U.S. Census Bureau AMERICAN FactFinder

MAIN SEARCH WHAT WE PROVIDE USING FACTFINDER

Search - Use the options on the left (topics, geographies, ...)

Your Selections

Search using...
County
Mercer County, Kentucky

Search using the options below:

- Topics** (age, income, year, dataset, ...)
- Geographies (states, counties, places, ...)
- Race and Ethnic Groups (race, ancestry, tribe)
- Industry Codes (NAICS industry, ...)

Search Results: 1-25 of 9,060 tables

Selected: View Download

Search for:

ID	Table, File or Document
DP00	Profile of General Population
DP02	SELECTED SOCIAL CHARACTERISTICS
DP03	SELECTED ECONOMIC CHARACTERISTICS
DP04	SELECTED HOUSING CHARACTERISTICS
DP05	ACS DEMOGRAPHIC AND HOUSING ESTIMATES

per page: 25

1 2 3 4 5

Here are the filters you can pick from.

Since we know we are looking for data from the American Community Survey, let's go ahead and select that filter.

To find it, click on "TOPICS"

U.S. Census Bureau AMERICAN FactFinder

MAIN SEARCH WHAT WE PROVIDE USING FACTFINDER Feedback FAQs Glossary Help

Search - Use the options on the left (topics, geographies, ...) to narrow your search results

Your Selections

Search using...
County
Mercer County, Kentucky

Search using the options below:

- Topics** (age, income, year, dataset, ...)
- Geographies (states, counties, places, ...)
- Race and Ethnic Groups (race, ancestry, tribe)
- Industry Codes (NAICS industry, ...)

Search Results: 1-25 of 9,060 tables and other products match 'Your Selections'

Selected: View Download

Search for:

Select Topics

Select Topics to add to 'Your Selections'

- + People
- + Housing
- + Business and Industry
- + Year
- + Product Type
- + Program**
- + Dataset

Include archived products in your search

2010 ACS 5-year estimates	i
2010 ACS 3-year estimates	i
2010 ACS 5-year estimates	i
2010 ACS 3-year estimates	i
2010 ACS 5-year estimates	i
2010 ACS 3-year estimates	i
2010 ACS 5-year estimates	i

per page: 25

5

Each of these open up to reveal more options.

Under "Topics," Click on "Program"

Search - Use the options on the left (topics, geographies, ...) to narrow your search results

Your Selections

Search using...
County
Mercer County, Kentucky

clear all selections and start a new search

Search using the options below:

Topics
(age, income, year, dataset, ...)

Geographies
(states, counties, places, ...)

Race and Ethnic Groups
(race, ancestry, tribe)

Industry Codes
(NAICS industry, ...)

Search Results: 1-25 of 9,060 tables and other products match 'Your Selections' per page: 25

Selected: View Download Compare Clear All

Search for: GO

ID	Table, File or Document Title	Dataset	About
	Profile of General Popul...		
	Program		
	American Community Survey (6,894)		
	Business Patterns (12)		
	Decennial Census (2,102)		
	Economic Census (29)		
	Nonemployer Statistics (6)		
	Population Estimates (10)		
	Survey of Business Owners (7)		

Click on "American Community Survey"

(If you make a mistake, CLICK HERE to remove the selection.)

Your Selections

Search using...
Program:
American Community Survey
County
Mercer County, Kentucky

clear all selections and start a new search

1. Now our selection box has 2 items:
American Community Survey
and
Mercer County, Kentucky.

2. The American Community Survey is no longer included in the "Program" filter list.

Search Results: 1-25 of 9,060 tables and other products match 'Your Selections' per page: 25

Selected: View Download Compare Clear All

Search for: GO

ID	Table, File or Document Title	Dataset	About
	Profile of General Popul...		
	Product Type		
	Program		
	Business Patterns (12)		
	Decennial Census (2,102)		
	Economic Census (29)		
	Nonemployer Statistics (6)		
	Population Estimates (10)		
	Survey of Business Owners (7)		

DP05 ACS DEMOGRAPHIC AND HOUSING ESTIMATES

DP05 ACS DEMOGRAPHIC AND HOUSING ESTIMATES

S0101 AGE AND SEX

Hidden behind the topics filter are your results.
 Now, the list includes EVERY table, for EVERY year, from EVERY dataset
 that contains estimates from the "American Community Survey"
and "Mercer County, Kentucky."

You can "Close" the Topics filter and pick from this list
OR you can narrow the list by using more filters.

Dataset	About
2010 ACS 3-year estimates	?
2010 ACS 5-year estimates	?
2010 ACS 3-year estimates	?
2010 ACS 5-year estimates	?
2010 ACS 3-year estimates	?
2010 ACS 5-year estimates	?
2010 ACS 3-year estimates	?
2010 ACS 5-year estimates	?
2010 ACS 3-year estimates	?
2010 ACS 5-year estimates	?

Since Mercer County has a population size of 20,000 + persons

*the American Community Survey
 has 2 kinds of estimates for Mercer County:*

*3-year estimates
 and
 5-year estimates*

*How many estimates are available will
 depend on the size of your county.*

To see the full list of datasets available for your county that are
 in the American Community Survey,
 we can pick another filter

To see a map of which estimates are available for counties in Kentucky, go to the "Resources for the American Community Survey" section of Kentucky: By The Numbers on the SNARL website (<http://www.ca.uky.edu/snarl/>).

Your Selections

Search using...

Program: American Community Survey

County: Mercer County, Kentucky

clear all selections and start a new search

Search using the options below:

Topics (age, income, year, dataset, ...)

Geographies (states, counties, places, ...)

Race and Ethnic Groups (race, ancestry, tribe)

Industry Codes (NAICS industry, ...)

Select Topics

Select Topics to add to 'Your Selections'

- People
- Housing
- Year
- Product Type
- Program
 - Business Patterns (12)
 - Decennial Census (2,102)
 - Economic Census (1)
 - Nonemployer Statistics (1)
 - Population Estimates (1)
 - Business Patterns (1)

Dataset

Include archived products in your search

per page: 25

Dataset	About
2010 ACS 3-year estimates	i
2010 ACS 5-year estimates	i
2010 ACS 3-year estimates	i
2010 ACS 5-year estimates	i
2010 ACS 3-year estimates	i
2010 ACS 5-year estimates	i
2010 ACS 3-year estimates	i
2010 ACS 5-year estimates	i
2010 ACS 3-year estimates	i
2010 ACS 5-year estimates	i

Your Selections

Search using...

Program: American Community Survey

County: Mercer County, Kentucky

clear all selections and start a new search

Search using the options below:

Topics (age, income, year, dataset, ...)

Geographies (states, counties, places, ...)

Race and Ethnic Groups (race, ancestry, tribe)

Industry Codes (NAICS industry, ...)

Select Topics

Select Topics to add to 'Your Selections'

- People
- Housing
- Year
- Product Type
- Program
- Dataset**
 - 2010 ACS 5-year estimates (911)
 - 2010 ACS 3-year estimates (1,411)
 - 2009 ACS 5-year estimates (669)
 - 2009 ACS 3-year estimates (1,280)
 - 2009 ACS 1-year estimates (1)
 - 2008 ACS 3-year estimates (1,259)
 - 2008 ACS 1-year estimates (1)
 - 2007 ACS 3-year estimates (1,359)
 - 2007 ACS 1-year estimates (1)
 - 2006 ACS (1)
 - 2005 ACS (1)

Include archived products in your search

per page: 25

Dataset	About
2010 ACS 3-year estimates	i
2010 ACS 5-year estimates	i
2010 ACS 3-year estimates	i

*I'll select the "2010 ACS 5-Year estimates."
(These data cover the 5 years of 2006 to 2010.)*

(If you make a mistake, CLICK HERE to remove the selection.)

Your Selections

Search using...

Program:
American Community Survey

Dataset:
2010 ACS 5-year estimates

County:
Mercer County, Kentucky

clear all selections and start a new search

1. Now the selection box has 3 items:
American Community Survey
"2010 ACS 5-Year estimates"
and
Mercer County, Kentucky.

2. "2010 ACS 5-Year estimates." is no longer included in the "Dataset" filter list.

3. Click "CLOSE"

Search Results: 7-25 of 817 tables and other products match 'Your Selections'

Select Topics to add to 'Your Selections'

- People
- Housing
- Product Type
- Dataset
 - 2010 ACS 3-year estimates (1,411)
 - 2009 ACS 5-year estimates (669)
 - 2009 ACS 3-year estimates (1,280)
 - 2009 ACS 1-year estimates (1)
 - 2008 ACS 3-year estimates (1,259)
 - 2008 ACS 1-year estimates (1)
 - 2007 ACS 3-year estimates (1,359)
 - 2007 ACS 1-year estimates (1)
 - 2006 ACS (1)
 - 2005 ACS (1)

Include archived products in your search

Dataset	About
2010 ACS 5-year estimates	?
2010 ACS 5-year estimates	?
2010 ACS 5-year estimates	?
2010 ACS 5-year estimates	?
2010 ACS 5-year estimates	?
2010 ACS 5-year estimates	?
2010 ACS 5-year estimates	?
2010 ACS 5-year estimates	?
2010 ACS 5-year estimates	?

Now, the results list includes EVERY table, from the American Community Survey that contains "2010 ACS 5-Year estimates" for "Mercer County, Kentucky."

FYI:
See how the list of Datasets only has the one that we picked:
"2010 ACS 5-Year estimates"

ID	Table, File or Document Title	Dataset	About
DP02	SELECTED SOCIAL CHARACTERISTICS IN THE UNITED STATES	2010 ACS 5-year estimates	?
DP03	SELECTED ECONOMIC CHARACTERISTICS	2010 ACS 5-year estimates	?
DP04	SELECTED HOUSING CHARACTERISTICS	2010 ACS 5-year estimates	?
DP05	ACS DEMOGRAPHIC AND HOUSING ESTIMATES	2010 ACS 5-year estimates	?
S0101	AGE AND SEX	2010 ACS 5-year estimates	?
S0102	POPULATION 60 YEARS AND OVER IN THE UNITED STATES	2010 ACS 5-year estimates	?
S0103	POPULATION 65 YEARS AND OVER IN THE UNITED STATES	2010 ACS 5-year estimates	?

Don't forget to scroll down

Each filter has sub-topics
and each of those have even more sub-topics.

(The same goes for "Geography," "Population Groups," and "Industry Codes.")

Since we selected BOTH a program and dataset,
the filters only listed those items available for that program AND dataset.

Remember, you can pick any of these in any order and
if you want to continue narrowing your search, you can pick more filters.

The image displays four overlapping screenshots of the 'Select Topics' dialog box, illustrating the hierarchical structure of filters and sub-topics. Each dialog box has a title bar with 'Search Results: 1-25 of 977 tables and other products match "Your Selections"', a 'CLOSE X' button, and a 'Select Topics' title. Below the title is a section 'Select Topics to add to "Your Selections" ?' with a help icon. At the bottom of each dialog is a checkbox 'Include archived products in your search ?'.

- Top-left dialog:** Shows a list of main categories with expandable icons (+): People, Housing, Product Type, and Dataset.
- Top-right dialog:** Shows the 'People' category expanded, listing sub-topics: Basic Count Estimate, Age & Sex, Age Group, Disability, Education, Employment, Income & Earnings, Insurance Coverage, Language, Marital & Fertility Status, Origins, Population Change, Poverty, Race & Ethnicity, Relationship, Veterans, Housing, and Product Type.
- Bottom-left dialog:** Shows the 'Housing' category expanded, listing sub-topics: Basic Count/Estimate (with sub-items: Housing Units (6), Living Quarters (3)), Financial Characteristic, Occupancy Characteristic, and Physical Characteristic.
- Bottom-right dialog:** Shows the 'Basic Count Estimate' sub-topic expanded, listing specific items: Civilian Population (56), Group Quarters Population (1), Household & Family (1), Population in Housing Units (11), and Population Total (4).

Your Selections

New information on same-sex couples from the 2010 ... will be released, including the number of ... couples and a set of preferred estimates of ... spouses and unmarried partners at the ... and state levels. These estimates were ... to account for data capture errors that ... difficult to measure same-sex couple

The 2010 American Community Survey (ACS) 1-year estimates, 2008-2010 ACS 3-year estimates, and the 2006-2010 ACS 5-year estimates are available in the new American FactFinder. ACS estimates from earlier years are currently available only in the legacy American FactFinder. These datasets will be available in the new American FactFinder in late 2011 or early

of 911 tables and other products match 'Your Selections' per page: 25

Download Compare Clear All ?

1 2 3 4 5

Search for: GO

the options below:

Topic (age, ... year, dataset, ...)

Geographic (states, counties, ...)

Race and Ethnic Groups (race, ancestry, tribe)

Industry Codes (NAICS industry, ...)

ID	Table, File or Document Title	Dataset	About
<input checked="" type="checkbox"/> DP02	SELECTED SOCIAL CHARACTERISTICS IN THE UNITED STATES	2010 ACS 5-year estimates	?
<input type="checkbox"/> DP03	SELECTED ECONOMIC CHARACTERISTICS	2010 ACS 5-year estimates	?
<input type="checkbox"/> DP04	SELECTED HOUSING CHARACTERISTICS		?
<input type="checkbox"/> DP05	ACS DEMOGRAPHIC AND HOUSING ESTIMATES		?
<input type="checkbox"/> S0101	AGE AND SEX		?
<input type="checkbox"/> S0102	POPULATION 60 YEARS AND OVER IN THE UNITED STATES		?
<input type="checkbox"/> S0103	POPULATION 65 YEARS AND OVER IN THE UNITED STATES	2010 ACS 5-year estimates	?
		2010 ACS 5-year	

The first 4 tables are the Data Profile Tables.
The Table ID begins with "DP"

I'll pick the "Selected Social Characteristics" Data Profile.

U.S. Census Bureau AMERICAN FactFinder

MAIN SEARCH WHAT WE PROVIDE USING FACTFINDER Feedback FAQs Glossary Help

Results - Click [Back to Search](#) to select other tables or geographies

BACK TO SEARCH Result 1 of 1 VIEW ALL AS PDF

DP02 SELECTED SOCIAL CHARACTERISTICS IN THE UNITED STATES
2006-2010 American Community Survey 5-Year Estimates

Table View Map View

Actions: [Modify Table](#) [Bookmark](#) [Print](#) [Download](#) [Cr...](#)

[View Geography Notes](#) [View Table](#)

Although the American Community Survey (ACS) produces population, demographic and housing unit estimates, for 2010, the 2010 Census provides the official counts of the ... and housing units for the nation, states, counties, cities and towns. For 2006 to 2009, the Population Estimates Program provides intercensal estimates of the population for the ... states, and counties.

Subject	Mercer County, Kentucky			
	Estimate	Estimate Margin of Error	Percent	Percent Margin of Error

If you don't see data, SCROLL DOWN

DP02 SELECTED SOCIAL CHARACTERISTICS IN THE UNITED STATES
2006-2009

Table View

Actions: Modify Table

Data Profile Tables in the American Community Survey
contain **estimates AND percents**

View Geographic Notes View Table Notes

Although the American Community Survey (ACS) produces population, demographic and housing unit estimates, for 2010, the 2010 Census provides the official counts of the population and housing units for the nation, states, counties, cities and towns. For 2006 to 2009, the Population Estimates Program provides intercensal estimates of the population for the nation, states, and counties.

Subject	Mercer County, Kentucky			
	Estimate	Estimate Margin of Error	Percent	Percent Margin of Error
HOUSEHOLDS BY TYPE				
Total households	8,464	+/-338	8,464	(X)
Family households (families)	5,959	+/-347	70.4%	+/-3.0
With own children under 18 years	2,289	+/-285	27.0%	+/-3.1
Married-couple family	4,781	+/-273	56.5%	+/-2.8
With own children under 18 years	1,721	+/-204	20.3%	+/-2.2
Male householder, no wife present, family	342	+/-95	4.0%	+/-1.1
With own children under 18 years	116	+/-67	1.4%	+/-0.8
Female householder, no husband present, family	836	+/-202	9.9%	+/-2.3
With own children under 18 years	452	+/-186	5.3%	+/-2.2
Nonfamily households	2,505			
Householder living alone	2,219			

(Don't forget to scroll down for more data)

Remember, both the estimates AND percents have a
"Margin of Error"

ALWAYS INCLUDE THESE WITH YOUR DATA

*If you have seen poll results reported in the news,
when they say "plus or minus 5 points," they are telling you the margin of error.*

View Table Notes

Subject	Mercer County, Kentucky			
	Estimate	Estimate Margin of Error	Percent	Percent Margin of Error
HOUSEHOLDS BY TYPE				
Total households	8,464	+/-338	8,464	(X)
Family households (families)	5,959	+/-347	70.4%	+/-3.0
With own children under 18 years	2,289	+/-285	27.0%	+/-3.1
Married-couple family	4,781	+/-273	56.5%	+/-2.8
With own children under 18 years	1,721	+/-204	20.3%	+/-2.2
Male householder, no wife present, family	342	+/-95	4.0%	+/-1.1
With own children under 18 years	116	+/-67	1.4%	+/-0.8
Female householder, no husband present, family	836	+/-202	9.9%	+/-2.3
With own children under 18 years	452	+/-186	5.3%	+/-2.2
Nonfamily households	2,505	+/-275	29.6%	+/-3.0
Householder living alone	2,219	+/-251	26.2%	+/-2.8

To learn more about margins of error, see "And Now for the Grain of Salt... Margins of Error and the American Community Survey" available on the Kentucky: By The Numbers section of the SNARL website (<http://www.ca.uky.edu/snarl/>).

Here are your data

According to the 2006-2010 American Community Survey 5-Year Estimates, 56.5% (+/- 2.8) of households in Mercer County, Kentucky are married couples.

Subject	Mercer County, Kentucky			
	Estimate	Estimate Margin of Error	Percent	Percent Margin of Error
HOUSEHOLDS BY TYPE				
Total households	8,464	+/-338	8,464	(X)
Family households (families)	5,959	+/-347	70.4%	+/-3.0
With own children under 18 years	2,289	+/-285	27.8%	+/-2.4
Married-couple family	4,761	+/-213	56.5%	+/-2.8
With own children under 18 years	1,721	+/-204	20.3%	+/-2.2
Male householder, no wife present, family	342	+/-95	4.0%	+/-1.1
With own children under 18 years	116	+/-67	1.4%	+/-0.8
Female householder, no husband present, family	836	+/-202	9.9%	+/-2.3
With own children under 18 years	452	+/-186	5.3%	+/-2.2
Nonfamily households	2,505	+/-275	29.6%	+/-3.0
Householder living alone	2,219	+/-251	26.2%	+/-2.8

Want to see data for a... different year? different topic? different county?
Click here to go back to the search page

AMERICAN FactFinder

MAIN SEARCH WHAT WE PROVIDE USING FACTFINDER Feedback FAQs Glossary Help

Result: [Back to Search](#) to select other tables or geographies

[← BACK TO SEARCH](#) [VIEW ALL AS PDF](#)

DP02 SELECTED SOCIAL CHARACTERISTICS IN THE UNITED STATES
2006-2010 American Community Survey 5-Year Estimates

Table View [Map View](#)

Actions: [Modify Table](#) [Bookmark](#) [Print](#) [Download](#) [Create a Map](#)

[View Geography Notes](#) [View Table Notes](#)

Although the American Community Survey (ACS) produces population, demographic and housing information for 2006 to 2010, the 2010 Census provides the official counts of the population and housing units for the nation, states, counties, cities and towns. For 2006 to 2009, the Population Estimates Program provides intercensal estimates of the population for the nation, states, and counties.

Subject

Want to see only parts of the table?
Click here to see lots of options

Want to download the table?
Click here.
(If you modify the table to only show parts of it, your modified table will be downloaded.)

For other graphical website instructions, see:

Getting Started... Finding Economic Data Online at the Bureau of Economic Analysis
 Getting Started... Finding Unemployment Data Online at the Bureau of Labor Statistics
 Getting Started... Finding Agriculture Data Online in the Census of Agriculture

These are all available on the
Kentucky: By The Numbers section of the SNARL website at:

<http://www.ca.uky.edu/snarl>

UK UNIVERSITY OF KENTUCKY
College of Agriculture

AGRICULTURE

College Home | Site Index | Search | People | Help

KENTUCKY: BY THE NUMBERS

- ▶ Kentucky By The Numbers
- ▶ Community Resource Publications
- ▶ Land Use Publications
- ▶ Rural Issues Briefs
- ▶ Welfare Reform Publications
- ▶ Additional Links

Kentucky: By The Numbers is an Extension program in the Department of Community and Leadership Development.

Primarily known for the data series by the same name, the program also provides publications and other resources for those interested in finding data on their county.

- ▶ Data Series
- ▶ Publications
- ▶ Resources for the American Community Survey
- ▶ Links to Additional Data Sites

Kentucky: By the Numbers is a program of the Kentucky Cooperative Extension Service in the Department of Community and Leadership Development at the University of Kentucky. Primarily known for the data series by the same name, the program also provides publications and other resources for those interested in finding data on their county. Data and resources are available on the Kentucky: By the Numbers section of the SNARL (<http://www.ca.uky.edu/snarl>) website. For more information contact your local Cooperative Extension office or Julie N. Zimmerman, Department of Community and Leadership Development, 500 Garrigus Building, University of Kentucky, Lexington, KY 40546-0215. Email: jzimm@email.uky.edu.